

Part. 269

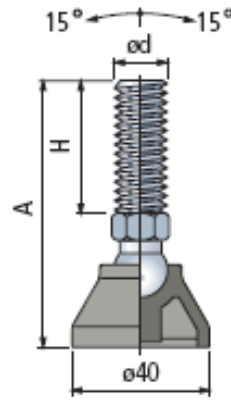

Standard

Made to Order

new **new**

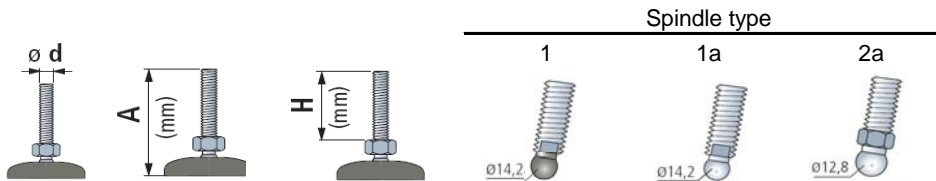

Spindle in stainless steel					
	A (mm)	H (mm)	1	1a	2a
M10	105	70	269/626503	-	269/625002
M12	100	70	269/626513	-	269/625012
	165	130	269/626523	-	269/625022
M14	100	70	-	269/626533	269/625032
M16	105	81	-	269/626543	269/625042
	165	124	-	269/626553	269/625052

Spindle in zinc plated steel					
	A (mm)	H (mm)	1	1a	2a
M8	70	40	-	-	269/625062
	65	33	-	-	269/625072
M10	105	71	-	-	269/625082
	150	118	-	-	269/625092
M12	80	48	-	-	269/625102
	100	69	-	-	269/625112
	130	96	-	-	269/625122
M14	100	68	-	-	269/625132
M16	80	47	-	-	269/625142
	100	67	-	-	269/625152
	200	167	-	-	269/625162

Part. 552

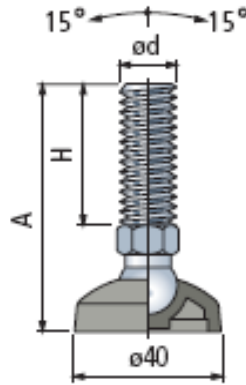

Standard

Made to Order

new **new**

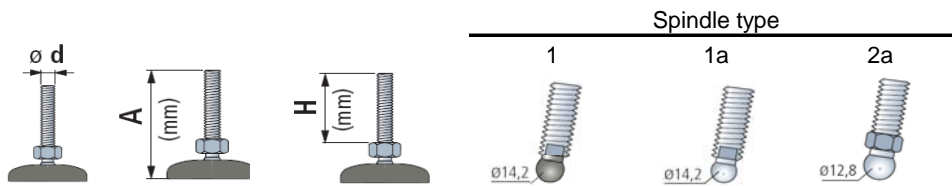

Spindle in stainless steel					
M10	95	70	552/626563	-	552/625502
M12	90	70	552/626573	-	552/625512
	155	130	552/626583	-	552/625522
M14	90	70	-	552/626593	552/625532
M16	95	81	-	552/626603	552/625542
	155	124	-	552/626613	552/625552

Spindle in zinc plated steel					
M8	60	40	-	-	552/625562
	55	33	-	-	552/625572
M10	95	71	-	-	552/625582
	140	118	-	-	552/625592
M12	70	48	-	-	552/625602
	90	69	-	-	552/625612
	120	96	-	-	552/625622
M14	90	68	-	-	552/625632
	70	47	-	-	552/625642
M16	90	67	-	-	552/625652
	190	167	-	-	552/625662

Part. 173

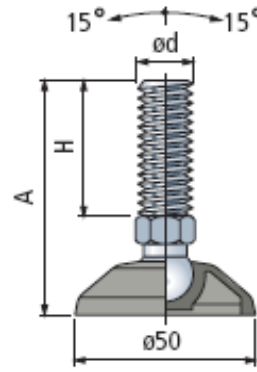

Standard	
Made to Order	
new	new

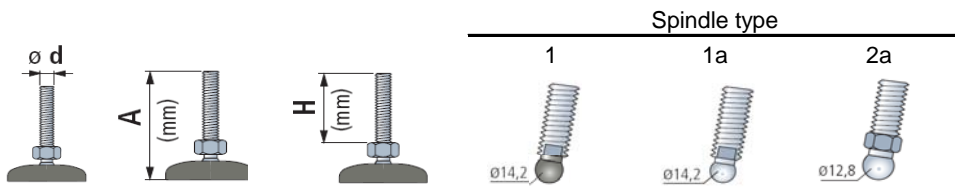

Spindle in stainless steel					
M10	95	70	173/626623	-	173/625252
	155	130	173/626643	-	173/625272
M12	90	70	173/626633	-	173/625262
M14	90	70	-	173/626653	173/625282
M16	95	81	-	173/626663	173/625292
	155	124	-	173/626673	173/625302

Spindle in zinc plated steel					
M8	60	40	-	-	173/625312
	55	33	-	-	173/625322
M10	95	71	-	-	173/625332
	140	118	-	-	173/625342
M12	70	48	-	-	173/625352
	90	69	-	-	173/625362
	120	96	-	-	173/625372
M14	90	68	-	-	173/625382
M16	70	47	-	-	173/625392
	90	67	-	-	173/625402
	190	167	-	-	173/625412

Part. 323

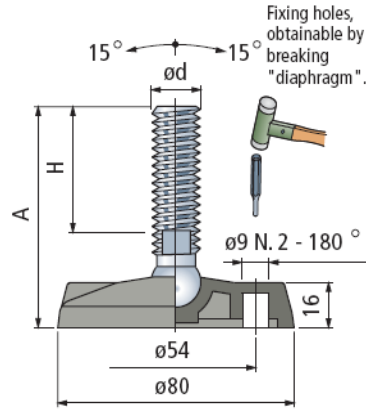

Standard

Made to Order

new **new**

Obsolete

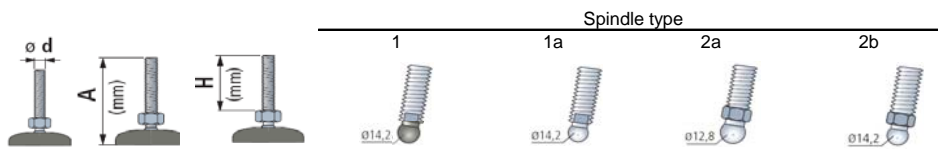

Spindle in stainless steel						
	A	H	1	1a	2a	2b
M10	95	70	323/626993	-	323/65686N	-
M12	90	70	323/627003	-	323/65596N	-
	155	130	323/627013	-	323/679061N	-
M14	95	68	-	-	323/626842	-
	105	76	-	323/626572	-	-
M16	95	64	-	323/626582	323/626852	-
	110	81	-	323/626592	-	-
	155	124	-	323/626602	323/626862	-
	180	151	-	323/626612	-	-
M20	115	84	-	323/626622	-	-
	180	149	-	323/626632	-	-
M24	180	146	-	323/626642	-	-

Spindle in zinc plated steel						
	A	H	1	1a	2a	2b
M8	65	40	-	-	323/678901N	-
	60	33	-	-	323/61384N	-
M10	95	71	-	-	323/60464N	-
	145	118	-	-	323/61404N	-
M12	70	48	-	-	323/61414N	-
	95	69	-	-	323/62313N	-
	120	96	-	-	323/678941N	-
M14	85	56	323/626662	-	-	-
	95	68	-	-	323/626832	-
M16	75	48	-	-	323/638022	323/685981N
	90	61	323/626672	-	323/638032	323/62353N
	115	89	-	-	-	323/686001N
	125	96	323/626682	-	-	-
	145	116	323/626692	-	-	-
	150	124	-	-	-	323/69932N
	155	130	-	-	-	323/686021N
180	151	323/626702	-	323/638042	323/62383N	
M20	230	201	323/627023	-	-	323/679021N
	130	100	323/626712	-	-	-
	180	150	323/626722	-	-	-
M24	245	214	323/626732	-	-	-
	115	81	323/626742	-	-	-
M24	180	146	323/626752	-	-	-

Part. 479

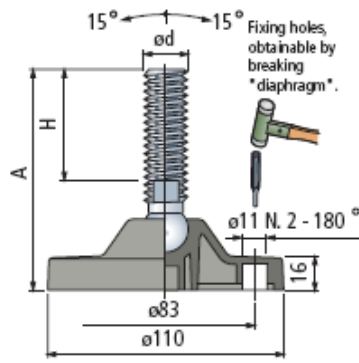

Standard

Made to Order

new **new**

Obsolete

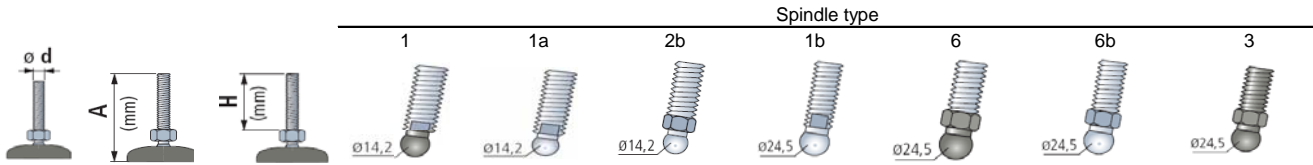

Spindle in stainless steel									
M12	110	55	479/627223	-	-	-	479/636181N	-	-
	160	100	479/627233	-	-	-	479/636201N	-	-
	205	150	479/627243	-	-	-	479/636221N	-	-
M14	120	76	479/633382	-	-	-	-	-	-
	160	100	479/627253	-	-	-	479/636261N	-	-
	205	150	479/627263	-	-	-	479/636271N	-	-
M16	110	64	-	479/633392	-	-	479/636331N	-	-
	125	81	-	479/633402	-	-	479/636371N	479/627422	-
	170	124	-	479/633412	-	-	479/636431N	479/627432	-
	195	151	-	479/633422	-	-	479/636471N	479/627442	-
	215	169	-	479/627273	-	-	-	479/627452	-
	235	190	-	479/627283	-	-	479/675591N	479/675591N1	-
M20	130	84	-	479/633432	-	479/627462	-	479/627462N	-
	195	149	-	479/633442	-	479/627472	-	479/627472N	-
	205	149	-	-	-	-	479/636741N	-	-
	255	208	-	479/627293	-	479/686561N	-	479/686561N1	-
M24	130	79	-	479/627303	-	-	-	479/627482	-
	195	146	-	479/633452	-	-	-	-	-
	230	179	-	479/627313	-	-	-	479/627492	-
	260	209	-	479/627323	-	479/636861N	-	479/636861N1	-

Spindle in zinc plated steel									
M12	115	70	479/627333	-	-	-	479/675341N	-	-
M16	90	48	-	479/633472	-	-	-	-	-
	105	61	-	479/627343	479/686621N	-	-	479/627532	-
	140	96	-	479/633482	479/675811N	-	-	479/627542	-
	160	116	-	479/633492	479/686661N	-	-	479/627542	-
	175	131	-	479/633502	479/675831N	-	-	-	-
	195	151	-	479/627353	479/686681N	-	-	479/627552	-
	210	165	-	479/633512	-	-	-	-	-
	245	201	-	479/627363	479/675851N	-	-	479/627562	-
M20	130	74	-	479/627373	479/675871N	-	-	-	-
	140	100	-	479/627383	-	479/627572	-	479/627572N	-
	160	113	-	479/633522	-	-	-	-	-
	190	150	-	479/627393	-	479/627582	-	479/627582N	-
M24	160	113	-	479/633532	-	479/627592	-	479/627592N	-
	260	214	-	479/633542	-	479/627602	-	479/627602N	-
	130	81	-	479/633552	-	-	-	479/627612	-
	195	146	-	479/633562	-	-	-	479/627622	-
	335	288	-	479/627403	-	479/675501N	-	479/675501N1	-

Spindle in reinforced polyamid (black) with steel pin									
M16	110	54	-	-	-	-	-	479/627502	-
M20	130	69	-	-	-	-	-	479/627512	-
	190	129	-	-	-	-	-	479/627522	-

Part. 171



Footplate in reinforced polyamide

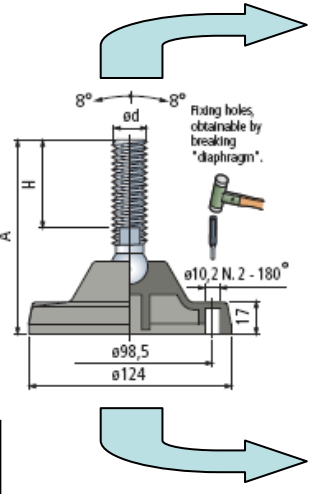

Part. 869

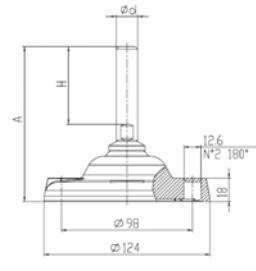

Part. 479

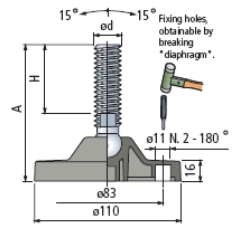

Standard

Made to Order

new new

Obsolete

Spindle type												A	H
		1a	2b	1b	6	6b	3	26	1	1a	6	NEW	NEW
ø d	A												
(mm)	(mm)												

Spindle in stainless steel - Footplate in PA FV															
M12	120	55	-	-	-	171/L681271N	-	-	-	479/627223	-	479/636181N	110	55	
	170	100	-	-	-	171/L681311N	-	-	-	479/627233	-	479/636201N	160	100	
	215	150	-	-	-	171/L681351N	-	-	-	479/627243	-	479/636221N	205	150	
M14	135	76	171/634142	-	-	-	-	-	-	-	-	479/633382	120	76	
	170	100	-	-	-	171/L681431N	-	-	-	-	-	479/627253	479/636261N	160	100
	215	150	-	-	-	171/L681471N	-	-	-	-	-	479/627263	479/636271N	205	150
M16	120	64	171/634162	-	-	171/L681551N	-	-	869/618903	-	-	-	110	50	
	135	74	-	-	-	171/L681591N	171/628052	-	869/618913	-	-	-	140	80	
	140	81	171/634182	-	-	-	-	-	869/618913	-	-	-	140	80	
	145	75	-	-	-	171/L600111N	-	-	869/618913	-	-	-	140	80	
	170	109	-	-	-	171/L681631N	171/628062	-	869/618923	-	-	-	170	110	
	180	124	171/634202	-	-	-	-	-	869/618923	-	-	-	170	110	
	205	144	-	-	-	171/L600131N	171/628072	-	869/618933	-	-	-	200	140	
	210	151	171/634222	-	-	-	-	-	869/618933	-	-	-	200	140	
M20	220	159	-	-	-	-	171/628082	-	869/618943	-	-	-	230	170	
	250	181	-	-	-	171/L681831N	-	-	869/618953	-	-	-	260	200	
	140	74	-	-	171/628092	-	-	-	869/618963	-	-	-	140	80	
	145	84	171/634242	-	-	-	-	-	869/618963	-	-	-	140	80	
	205	139	-	-	171/628102	-	-	-	869/618973	-	-	-	200	140	
	210	149	171/634262	-	-	-	-	-	869/618973	-	-	-	200	140	
	215	149	-	-	-	171/L681991N	-	-	869/618973	-	-	-	200	140	
M24	270	204	-	-	171/687531N	-	-	-	869/618983	-	-	-	260	200	
	140	79	-	-	-	-	171/628112	-	869/619003	-	-	-	140	80	
	210	146	171/634282	-	-	-	-	-	869/619013	-	-	-	210	150	
	240	179	-	-	-	-	171/628122	-	869/619023	-	-	-	240	180	
	280	216	-	-	171/682281N	-	-	-	869/619033	-	-	-	270	210	

Spindle in zinc plated steel - Footplate in PA FV														
M12	130	64	-	-	-	171/L680671N	-	-	-	479/627333	-	479/675341N	120	64
M14	115	56	171/634322	-	-	-	-	-	-	-	-	479/633472	100	56
	100	48	-	171/L687651N	-	-	-	-	869/619073	-	-	-	110	50
M16	115	54	-	-	-	-	171/628162	-	869/619073	-	-	-	110	50
	120	61	171/634342	171/L69509N	-	-	-	-	869/619073	-	-	-	110	50
	145	89	-	171/L687731N	-	-	-	-	869/619083	-	-	-	140	80
	150	89	-	-	-	-	171/628172	-	869/619083	-	-	-	140	80
	155	96	171/634362	-	-	-	-	-	869/619083	-	-	-	140	80
	175	116	171/634382	-	-	-	-	-	869/619093	-	-	-	170	110
	180	124	-	171/L682441N	-	-	171/628182	-	869/619093	-	-	-	170	110
	185	130	-	171/L687771N	-	-	-	-	869/619093	-	-	-	170	110
	210	151	171/634402	-	-	-	-	-	869/619103	-	-	-	200	140
	215	154	-	-	-	-	171/628192	-	869/619103	-	-	-	200	140
M20	220	165	-	171/L69549N	-	-	-	-	869/619113	-	-	-	230	170
	255	201	-	171/L682481N	-	-	-	-	869/619123	-	-	-	260	200
	140	74	-	-	171/628202	-	-	-	869/619133	-	-	-	140	80
	155	100	171/634422	-	-	-	-	-	869/619143	-	-	-	170	110
	175	106	-	-	171/628212	-	-	-	869/619143	-	-	-	170	110
	205	150	171/634442	-	171/628222	-	-	-	869/619153	-	-	-	200	140
	270	204	-	-	171/628232	-	-	-	869/619173	-	-	-	260	200
	275	214	171/634462	-	-	-	-	-	869/619173	-	-	-	260	200
	140	79	-	-	-	-	171/628242	-	869/619193	-	-	-	140	80
	145	81	171/634482	-	-	-	-	-	869/619193	-	-	-	140	80
M24	205	144	-	-	-	171/628252	-	-	869/619213	-	-	-	200	140
	210	146	171/634502	-	-	-	-	-	869/619213	-	-	-	200	140
	350	288	-	-	171/681231N	-	-	-	869/619243	-	-	-	350	290

Spindle in reinforced polyamid (black) with steel pin - Footplate in PA FV														
M16	120	54	-	-	-	-	171/628132	869/619073	-	-	-	-	110	50
M20	140	69	-	-	-	-	171/628142	869/619133	-	-	-	-	140	80
	205	129	-	-	-	-	171/628152	869/619153	-	-	-	-	200	140

Part. 171



Footplate in reinforced polypropylene

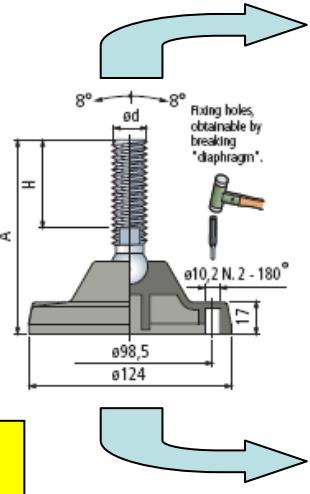

Part. 869

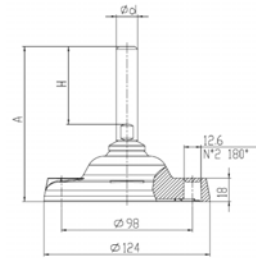

Part. 479

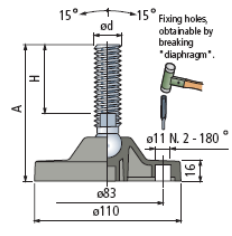

Standard

Made to Order

new **new**

Obsolete

		Spindle type										A	H
		1a	2b	1b	6	6b	3	26	1	1a	6	NEW	NEW
		ød	A	H	ød	A	H	ød	A	H	ød	A	H

Spindle in stainless steel - Footplate in PP FV														
M12	120	55	-	-	-	171/L681291N	-	-	-	479/627223	-	479/636181N	110	55
	170	100	-	-	-	171/L681331N	-	-	-	479/627233	-	479/636201N	160	100
	215	150	-	-	-	171/L681371N	-	-	-	479/627243	-	479/636221N	205	150
M14	135	76	171/634152	-	-	-	-	-	-	-	-	479/633382	120	76
	170	100	-	-	-	171/L681451N	-	-	-	-	-	479/627253	160	100
	215	150	-	-	-	171/L681491N	-	-	-	-	-	479/627263	205	150
M16	120	64	171/634172	-	-	171/L681571N	-	-	-	869/619283	-	-	110	50
	135	74	-	-	-	171/L681611N	171/628502	-	-	869/619293	-	-	140	80
	140	81	171/634192	-	-	-	-	-	-	869/619293	-	-	140	80
	145	75	-	-	-	171/L600071N	-	-	-	869/619293	-	-	140	80
	170	109	-	-	-	171/L681651N	171/628512	-	-	869/619303	-	-	170	110
	180	124	171/634212	-	-	-	-	-	-	869/619303	-	-	170	110
	205	144	-	-	-	171/L600091N	171/628522	-	-	869/619313	-	-	200	140
	210	151	171/634232	-	-	-	-	-	-	869/619313	-	-	200	140
	220	159	-	-	-	-	171/628532	-	-	869/619323	-	-	230	170
	250	181	-	-	-	171/L681851N	-	-	-	869/619333	-	-	260	200
M20	140	74	-	-	171/628542	-	-	-	-	869/619343	-	-	140	80
	145	84	171/634252	-	-	-	-	-	-	869/619343	-	-	140	80
	205	139	-	-	171/628552	-	-	-	-	869/619353	-	-	200	140
	210	149	171/634272	-	-	-	-	-	-	869/619353	-	-	200	140
	215	149	-	-	-	171/L682021N	-	-	-	869/619353	-	-	200	140
M24	270	204	-	-	171/687551N	-	-	-	-	869/619363	-	-	260	200
	140	79	-	-	-	-	171/628562	-	-	869/619383	-	-	140	80
	210	146	171/634292	-	-	-	-	-	-	869/619393	-	-	210	150
	240	179	-	-	-	-	171/628572	-	-	869/619403	-	-	240	180
	280	216	-	-	171/682301N	-	-	-	-	869/619413	-	-	270	210

Spindle in zinc plated steel - Footplate in PP FV														
M12	130	64	-	-	-	171/L680691N	-	-	-	479/627333	-	479/675341N	120	64
M14	115	56	171/634332	-	-	-	-	-	-	-	-	479/633472	100	56
	100	48	-	171/L687671N	-	-	-	-	-	869/619453	-	-	110	50
M16	115	54	-	-	-	-	171/628582	-	-	869/619453	-	-	110	50
	120	61	171/634352	171/L69499N	-	-	-	-	-	869/619453	-	-	110	50
	145	89	-	171/L687751N	-	-	-	-	-	869/619463	-	-	140	80
	150	89	-	-	-	-	171/628592	-	-	869/619463	-	-	140	80
	155	96	171/634372	-	-	-	-	-	-	869/619463	-	-	140	80
	175	116	171/634392	-	-	-	-	-	-	869/619473	-	-	170	110
	180	124	-	171/L682461N	-	-	171/628602	-	-	869/619473	-	-	170	110
	185	130	-	171/L687791N	-	-	-	-	-	869/619473	-	-	170	110
	210	151	171/634412	-	-	-	-	-	-	869/619483	-	-	200	140
	215	154	-	-	-	-	171/628612	-	-	869/619483	-	-	200	140
M20	220	165	-	171/L69539N	-	-	-	-	-	869/619493	-	-	230	170
	255	201	-	171/L682501N	-	-	-	-	-	869/619503	-	-	260	200
	140	74	-	-	171/628622	-	-	-	-	869/619513	-	-	140	80
	155	100	171/634432	-	-	-	-	-	-	869/619523	-	-	170	110
	175	106	-	-	171/628632	-	-	-	-	869/619523	-	-	170	110
	205	150	171/634452	-	171/628642	-	-	-	-	869/619533	-	-	200	140
	270	204	-	-	171/628652	-	-	-	-	869/619553	-	-	260	200
	275	214	171/634472	-	-	-	-	-	-	869/619553	-	-	260	200
	140	79	-	-	-	-	171/628662	-	-	869/619573	-	-	140	80
	145	81	171/634492	-	-	-	-	-	-	869/619573	-	-	140	80
M24	205	144	-	-	-	-	171/628672	-	-	869/619593	-	-	200	140
	210	146	171/634512	-	-	-	-	-	-	869/619593	-	-	200	140
	350	288	-	-	171/681251N	-	-	-	-	869/619623	-	-	350	290

Spindle in reinforced polyamid (black) with steel pin - Footplate in PP FV														
M16	120	54	-	-	-	-	171/628472	-	-	869/619453	-	-	110	50
	140	69	-	-	-	-	171/628482	-	-	869/619513	-	-	140	80
M20	205	129	-	-	-	-	171/628492	-	-	869/619533	-	-	200	140

Part. 169

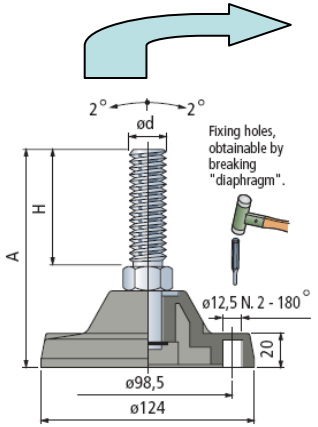

Part. 869

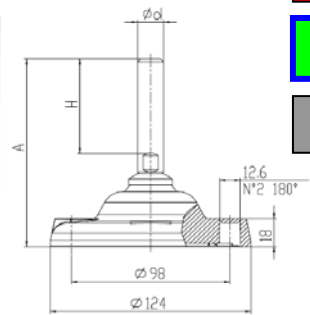

Footplate in reinforced polyamide

Standard
Made to Order
new new
Obsolete

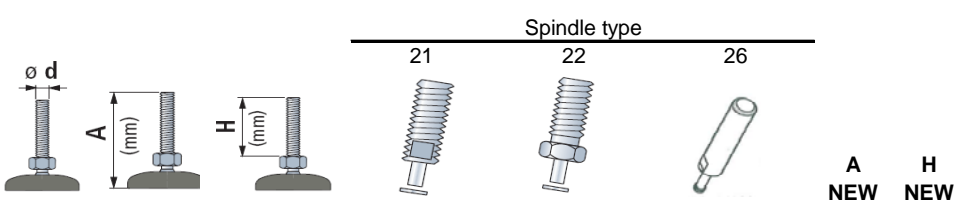

Spindle in stainless steel - Footplate in PA FV

M16	255	200	169/604993	-	869/618953	260	200
	140	81	-	169/624802	869/618963	140	80
M20	205	146	-	169/624812	869/618973	200	140
	270	218	169/611523	-	869/618993	290	230
M24	205	152	169/624822	-	869/619013	210	150
M30	205	152	169/624832	-	869/619053	215	150

Spindle in zinc plated steel - Footplate in PA FV

M16	255	200	-	169/624842	869/619123	260	200
	255	200	169/604983	-	869/619123	260	200
M20	140	81	-	169/624852	869/619133	140	80
	205	146	-	169/624862	869/619153	200	140
	205	154	169/611653	-	869/619153	200	140
	255	195	-	169/624872	869/619173	260	200
M24	308	242	-	169/611663	869/619183	290	230
	145	91	169/624882	-	869/619193	140	80
	205	152	169/624892	-	869/619213	200	140

Part. 169

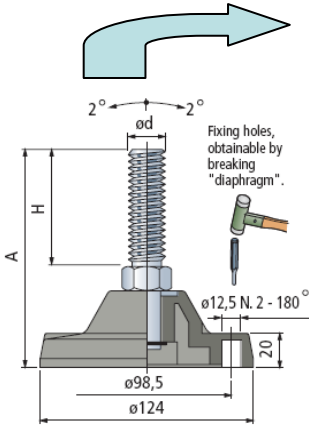

Part. 869

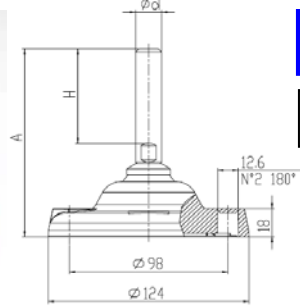

Standard

Made to Order

new **new**

Obsolete

Footplate in reinforced polypropylene

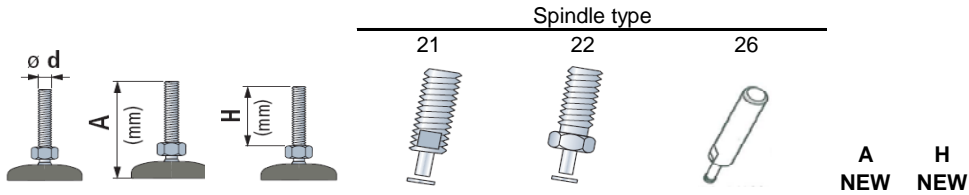

Spindle in stainless steel - Footplate in PP FV

	A	H			A	H	
M20	140	81	-	169/628682	869/619343	140	80
	205	146	-	169/628692	869/619353	200	140
	270	218	169/611633	-	869/619373	290	230
M24	205	152	169/628702	-	869/619393	210	150
M30	205	152	169/628712	-	869/619433	215	150

Spindle in zinc plated steel - Footplate in PP FV

	A	H			A	H	
M16	255	200	-	169/628722	869/619503	260	200
M20	140	81	-	169/628732	869/619513	140	80
	205	146	-	169/628742	869/619533	200	140
	205	154	169/636162	-	869/619533	200	140
	255	195	-	169/628752	869/619553	260	200
	308	242	-	169/611673	869/619563	290	230
M24	145	91	169/628762	-	869/619573	140	80
	205	152	169/628772	-	869/619593	200	140

Part. 297

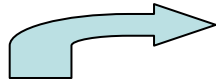

Part. 869

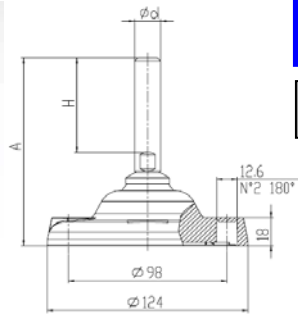
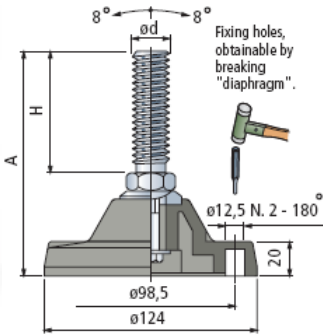

Standard

Made to Order

new **new**

Obsolete

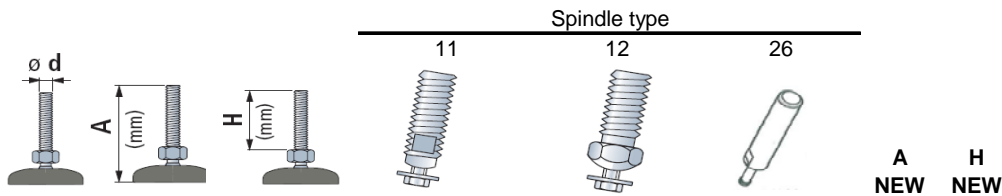

Spindle in stainless steel				A		H	
				NEW		NEW	
M16	175	118	297/629182	869/618923	170	110	
	205	148	297/629192	869/618933	200	140	
M20	205	148	297/629202	869/618973	200	140	
M24	230	165	297/680371N	-	869/619023	240	180
M30	190	120	297/629212	-	869/619043	185	120
	250	180	297/629222	-	869/619063	245	180
Spindle in zinc plated steel				A		H	
M20	155	100	297/629232	869/619143	170	110	
	195	140	297/629242	869/619153	200	140	
M30	190	120	297/629252	-	869/619253	185	120
	250	180	297/629262	-	869/619263	245	180
	325	250	297/688071N	-	869/619273	315	250



Articulated Feet Gripper

in reinforced polypropylene

mar/bett®

Part. 626

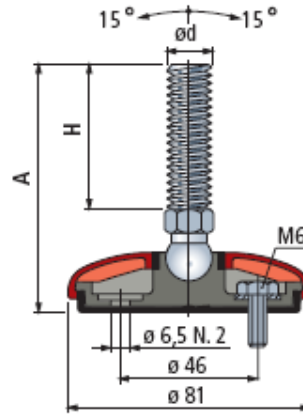

Standard	
Made to Order	
new	new
Obsolete	

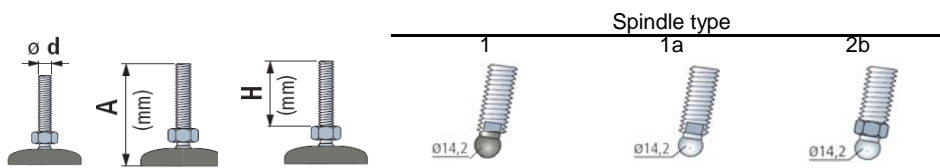

Spindle in stainless steel					
M10	100	70	626/627533	-	626/641392
M12	85	55	626/627543	-	626/641402
	145	115	626/627553	-	626/641412
M14	110	76	-	626/641712	-
	100	64	-	626/641722	-
M16	115	81	-	626/641732	-
	160	124	-	626/641742	-
	185	151	-	626/641752	-
M20	120	84	-	626/641762	-
	185	149	-	626/641772	-
M24	185	146	-	626/641782	-

Spindle in zinc plated steel					
M10	60	30	626/602603	-	626/641522
	95	65	626/627563	-	626/641532
	145	115	626/627573	-	626/641542
M12	65	35	626/627583	-	626/641552
	100	70	626/627593	-	626/641562
	120	90	626/627603	-	626/641572
M14	90	56	-	626/641792	-
	80	48	-	-	626/641592
M16	95	61	-	626/641812	626/641602
	130	96	-	626/641822	626/641612
	150	116	-	626/641832	626/643052
	185	151	-	626/641842	626/641632
	235	201	-	626/627613	626/641642
M20	135	100	-	626/641862	-
	185	150	-	626/641872	-
	250	214	-	626/641882	-
M24	120	81	-	626/641892	-
	185	146	-	626/641902	-

Part. 627

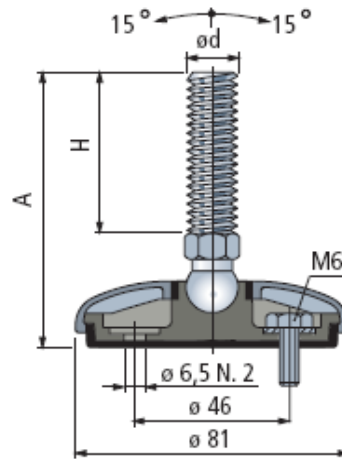

Standard

Made to Order

new **new**

Obsolete

Spindle type

		1		1a		2b	
$\varnothing d$	A (mm)	$\varnothing 14,2$	$\varnothing 14,2$	$\varnothing 14,2$	$\varnothing 14,2$	$\varnothing 14,2$	$\varnothing 14,2$
H (mm)		Code	Code	Code	Code	Code	Code
		feet with cap supplied assembled	feet with cap* supplied disassembled	feet with cap supplied assembled	feet with cap* supplied disassembled	feet with cap supplied assembled	feet with cap* supplied disassembled

Spindle in stainless steel

Spindle	A (mm)	H (mm)	Code (assembled)	Code (disassembled)	Code (assembled)	Code (disassembled)	Code (assembled)	Code (disassembled)
M10	100	70	627/627623	627/627653	-	-	627/641972	627/647292
M12	85	55	627/627633	627/627663	-	-	627/641982	627/647302
	145	115	627/627643	627/627673	-	-	627/641992	627/647312
M14	110	76	-	-	627/642102	627/647322	-	-
	100	64	-	-	627/642112	627/647332	-	-
	115	81	-	-	627/642122	627/647342	-	-
	160	124	-	-	627/642132	627/647352	-	-
	185	151	-	-	627/642142	627/647362	-	-
M20	120	84	-	-	627/642152	627/647372	-	-
	185	149	-	-	627/642162	627/647382	-	-
M24	185	146	-	-	627/642172	627/647392	-	-

Part. 622

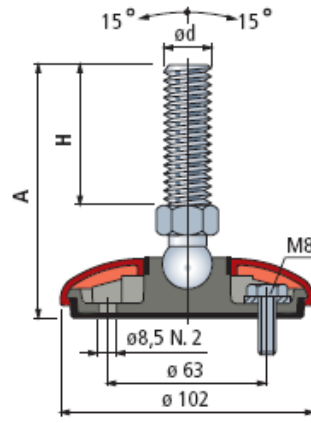

Standard	
Made to Order	
new	new
Obsolete	

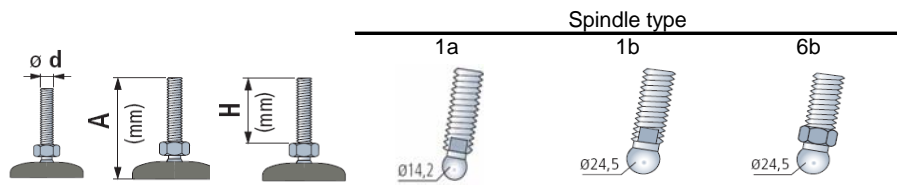

Spindle in stainless steel					
M14	115	76	622/643542	-	-
	105	64	622/643552	-	-
M16	120	81	622/643562	622/640362	622/637262
	150	100	622/640372N	622/640372	622/637272
	165	124	622/643572	-	-
	190	151	622/643582	622/640382	622/637282
	200	150	622/640392N	622/640392	622/637292
M20	125	84	622/643592	622/637302	622/637442
	190	149	622/643602	622/637312	622/637452
M24	120	74	622/640402N	622/640402	622/637322
	190	146	622/643612	-	-
	220	172	622/640412N	622/640412	622/637332

Spindle in zinc plated steel					
M14	95	56	622/643622	-	-
M16	100	61	622/643632	622/640422	622/637342
	135	96	622/643642	622/640432	622/637352
	155	116	622/643652	622/640442	622/637362
	190	151	622/643662	622/640452	622/637372
M20	120	74	622/637382N	622/637382	622/637462
	140	100	622/643672	-	-
	155	106	622/637392N	622/637392	622/637472
	190	150	622/643682	622/637402	622/637482
M24	255	214	622/643692	622/637412	622/637492
	125	81	622/643702	622/640462	622/637422
	190	146	622/643712	622/640472	622/637432

Part. 623

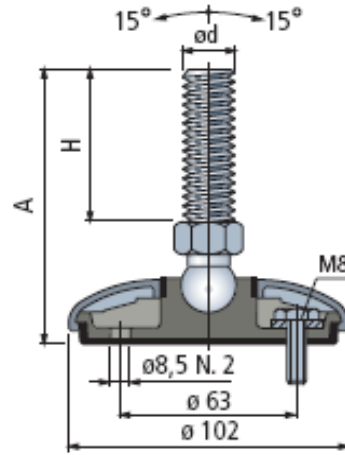

Standard	
Made to Order	
new	new
Obsolete	

Spindle type

		1a		1b		6b	
		ø14,2		ø24,5		ø24,5	
	$\frac{\text{ø d}}{\text{A (mm)}}$	Code feet with cap supplied assembled	Code feet with cap* supplied disassembled	Code feet with cap supplied assembled	Code feet with cap* supplied disassembled	Code feet with cap supplied assembled	Code feet with cap* supplied disassembled

Spindle in stainless steel

M14	115	76	623/643722	623/647402				
	105	64	623/643732	623/647412				
	120	81	623643742	623/647442	623/640482	623/647432	623/637512	623/647422
M16	150	100	623/640492N	623/647462N	623/640492	623/647462	623/637522	623/647452
	165	124	623/643752	623647472				
	190	151	623/643762	623/647502	623/640502	623/647492	623/637532	623/647482
	200	150	623/640512N	623/647522N	623/640512	623/647522	623/637542	623/647512
M20	125	84	623/643772	623/647552	623/637552	623/647542	623/637692	623/647532
	190	149	623/643782	623/647582	623/637562	623/647572	623/637702	623/647562
M24	120	74	623/640522N	623/647602N	623/640522	623/647602	623/637572	623/647592
	190	146	623/643792	623/647612				
	220	172	623/640532N	623/647632N	623/640532	623/647632	623/637582	623/647622

Part. 628

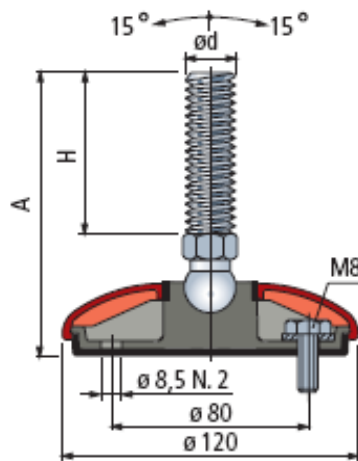

Standard

Made to Order

new **new**

Obsolete

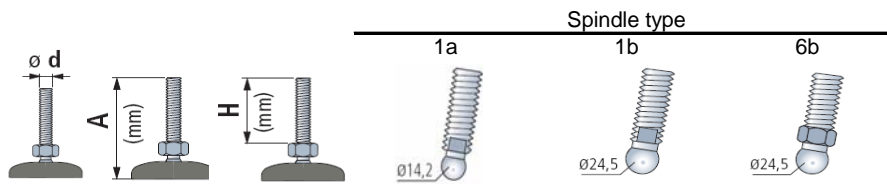

Spindle in stainless steel					
M14	120	76	628/643802	-	-
	110	64	628/643812	-	-
M16	125	81	628/643822	628/642452	628/642442
	155	100	628/642472N	628/642472	628/642462
	170	124	628/643832	-	-
	195	151	628/643842	628/642492	628/642482
	205	150	628/642512N	628642512	628/642502
M20	130	84	628/643852	628/642532	628/642522
	195	149	628/643862	628/642552	628/642542
M24	125	74	628/642572N	628/642572	628/642562
	195	146	628/643872	-	-
	225	172	628/642592N	628/642592	628/642582

Spindle in zinc plated steel					
M14	100	56	628/643882	-	-
	105	61	628/643892	628/642612	628/642602
M16	140	96	628/643902	628/642632	628/642622
	160	116	628/643912	628/642652	628/642642
	195	151	628/643922	628/642672	628/642662
M20	125	74	628/642692N	628/642692	628/642682
	145	100	628/643932	-	-
	160	106	628/642712N	628/642712	628/642702
	195	150	628/643942	628/642732	628/642722
	260	214	628/643952	628/642752	628/642742
M24	130	81	628/643962	628/642772	628/642762
	195	146	628/643972	628/642792	628/642782

Part. 629

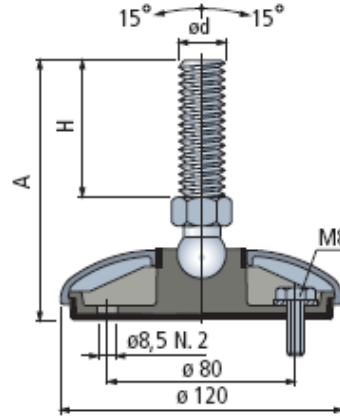







Standard

Made to Order

new new

Obsolete

Spindle type

		1a		1b		6b	
							
		Code	Code	Code	Code	Code	Code
		feet with cap supplied assembled	feet with cap* supplied disassembled	feet with cap supplied assembled	feet with cap* supplied disassembled	feet with cap supplied assembled	feet with cap* supplied disassembled

Spindle in stainless steel

	ø d	A (mm)	H (mm)	Code	Code	Code	Code	Code	Code
M14	120	76		629/643982	629/647642	-	-	-	-
	110	64		629/643992	629/647652	-	-	-	-
M16	125	81		629/644002	629/647682	629/642292	629/647672	629/642282	629/647662
	155	100		629/642312N	629/647702N	629/642312	629/647702	629/642302	629/647692
	170	124		629/644012	629/647712	-	-	-	-
	195	151		629/644022	629/647742	629/642332	629/647732	629/642322	629/647722
	205	150		629/642352N	629/647762N	629/642352	629/647762	629/642342	629/647752
M20	130	84		629/644032	629/647792	629/642372	629/647782	629/642362	629/647772
	195	149		629/644042	629/647822	629/642392	629/647812	629/642382	629/647802
M24	125	74		629/642412N	629/647842N	629/642412	629/647842	629/642402	629/647832
	195	146		629/644052	629/647852	-	-	-	-
	225	172		629/642432N	629/647872N	629/642432	629/647872	629/642422	629/647862



Part. 549-546-547-548

Standard

Made to Order

new **new**

Obsolete

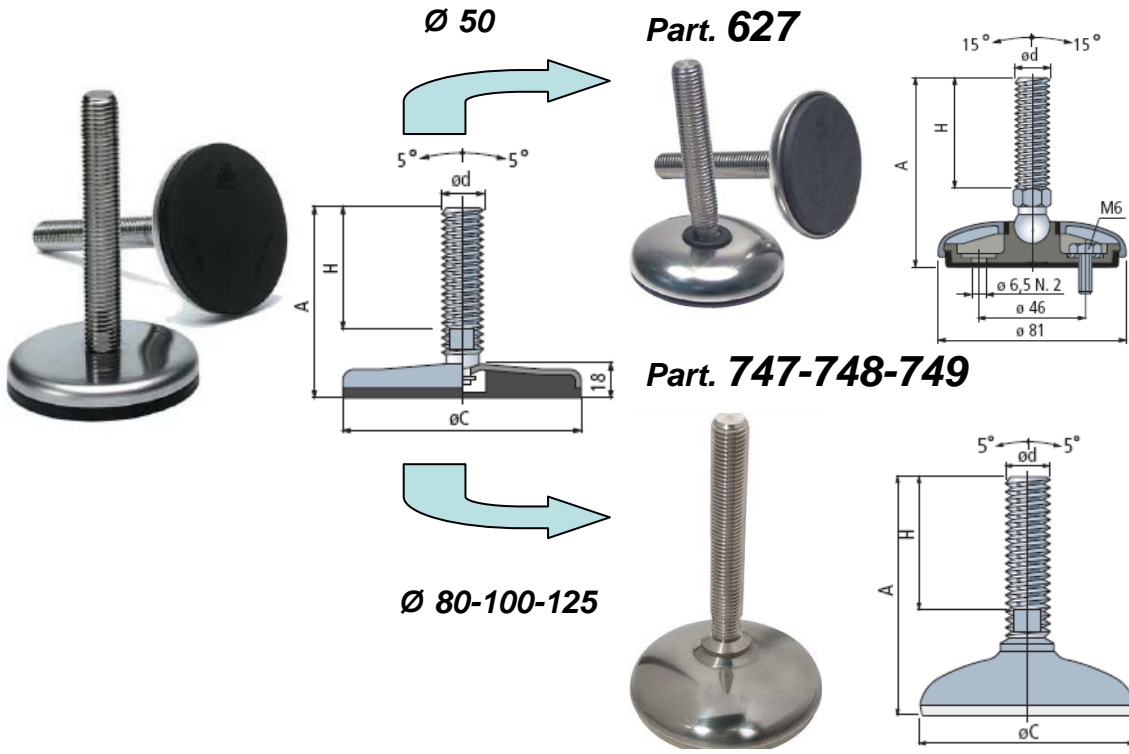

Ø 80-100-125

Ø C mm	A (mm)	H (mm)	Spindle type					A NEW	H NEW
			13	1	1a	2b	23		
				ø14,2	ø14,2	ø14,2			

Part 549										
Ø 50	M12	75	44	549/632372	627/627663	627/647302	85	55		
		100	66	549/632382	627/627663	627/647302	85	55		
		150	119	549/632392	627/627673	627/647312	145	115		
		175	144	549/632402	627/627673	627/647312	145	115		
	M16	75	47	549/632412	627/647332		100	64		
		125	97	549/632422	627/647342		115	81		
		175	148	549/632432	627/647362		185	151		

Part 546										
Ø 80	M16	175	148	546/684791			182	136		
	M20	175	148	546/684811			187	139		
	M24	205	165	546/684821			217	167		
	M30	160	115	546/684831			165	115		
		220	175	546/684841			215	165		

Part 547										
Ø 100	M16	175	148	547/684951			185	136		
	M20	175	148	547/684971			190	139		
	M24	205	165	547/684981			220	167		
	M30	160	115	547/684991			168	115		
		220	175	547/685001			218	165		

Part 548										
Ø 125	M16	175	148	548/685111			190	136		
	M20	175	148	548/685131			195	139		
	M24	205	165	548/685141			225	167		
	M30	160	115	548/685151			173	115		
		220	175	548/685161			223	165		